

SR20 FD and FP cylinders

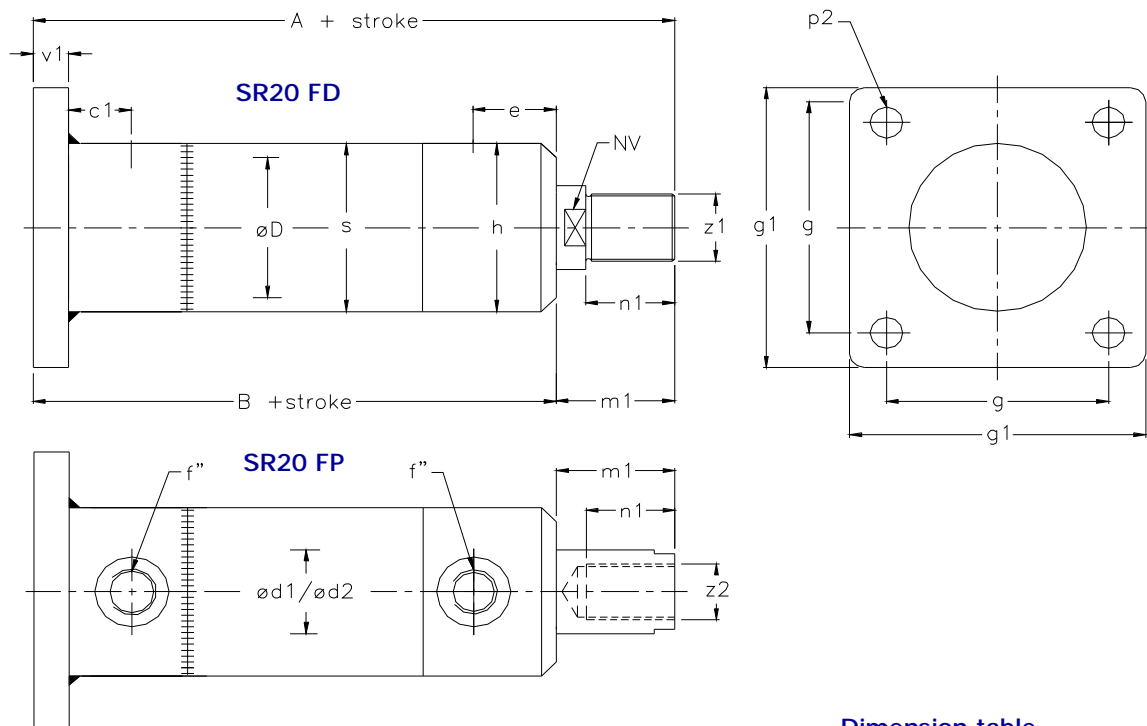

Dimension table

øD	25	32	40	50	63	80
ød1/ød2	12/16	16	20/25	25/30	30/40	40/50
A	127	156	172	204	224	267
B	96	127	137	164	179	207
c1	13	16	17	21	22	26
e	26	24	25	28	28	39
f''	1/8 "	1/4 "	1/4 "	3/8 "	3/8 "	1/2 "
g	50	50	65	75	85	110
g1	70	70	90	100	120	140
h	40	50	50/55	60	75	100
m1	31	29	35	40	45	60
n1	24	22	25	30	35	40
NV	10	13	17/22	22/27	27/36	42
p2	9	9	11	11	14	14
s	30	40	50	60	75	95
z1	M10x1,50 M12x1,75	M12x1,75	M16x2,00 M22x2,00	M22x2,00 M24x1,50	M24x1,50 M36x2,00	M36x2,00 M36x2,00
z2	M8x1,25	M8x1,25	M12x1,75 M16x2,00	M16x2,00 M20x2,50	M20x2,50 M24x2,00	M24x2,00 M24x2,00
v1	8	9	9	11	15	18

How to order:



SR20 FD x1 / x2 * x3 K

x1: Inside diameter : 50 mm
 x2: Piston rod : 30 mm
 x3: Stroke : 200 mm

Ordering code: SR20 FD 50/30*200 K

Eksempel på ordre:



SR20 FD x1 / x2 * x3 K

x1: Indvendig diameter : 50 mm
 x2: Stempelstang : 30 mm
 x3: Slaglængde : 200 mm

Ordre kode: SR20 FD 50/30*200 K